

USERS GUIDE DIGITAL 3-BUTTON TRANSMITTER

PRODUCT DESCRIPTION

The TD390 series (PN:10TD390KEYCHAIN, 10TD390MINIPB) is a three-button miniature transmitter available in hand-held and pushplate styles. The Transmitter sends a unique code each time the switch is closed. A 12-volt type 23A battery powers the transmitter, and a red indicator lights when the transmitter is activated.

INSTALLING / REPLACING THE BATTERY



1. Remove screw from back of transmitter

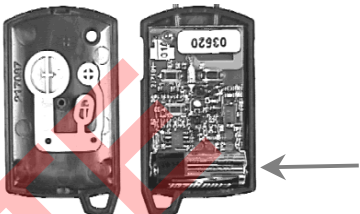

2. Separate housing and install a fresh 12-Volt Type 23A battery
3. Reassemble housing and replace screw.

OPERATION



The transmitter may be used as a hand-held device, or may also be used with a push plate if supplied with two pre-attached wires. To program the transmitter to the corresponding receiver, perform the following:

Hand-Held Configuration	For Use With Push Plate
<ol style="list-style-type: none"> On the 390MHz digital receiver, press the learn button once. Depress the large round button on the transmitter once, then press it again. Repeat steps 1 and 2 for the remaining two buttons on the transmitter, if applicable. The transmitter has now been "learned" by the receiver and should operate normally. 	<ol style="list-style-type: none"> Before beginning, it is easiest to have already installed the push plate, and to have the transmitter wires already attached to the push plate switch. Please note: the two pre-attached wires correspond only to the large round button on the transmitter. On the 390MHz digital receiver, press the learn button once. Depress the push plate, or large round button on the transmitter, once. Then press it again. The transmitter has now been "learned" by the receiver and should operate normally.

SAFETY PRECAUTIONS



- Shut off all power going to the header before attempting any wiring procedures.
- Maintain a clean & safe environment when working in public areas.
- Constantly be aware of pedestrian traffic around the door area.
- Always stop pedestrian traffic through the doorway when performing tests that may result in unexpected reactions by the door.
- Always check placement of all wiring before powering up to insure that moving door parts will not catch any wires and cause damage to equipment.
- Ensure compliance with all applicable safety standards (i.e. ANSI A156.10) upon completion of installation.

COMPANY CONTACT

If after troubleshooting a problem, a satisfactory solution cannot be achieved, please call B.E.A., Inc. for further assistance during **Eastern Standard Time at 1-800-523-2462 from 8am - 5pm**. For after-hours, call East Coast: 1-866-836-1863 or 1-800-407-4545 / Mid-West: 1-888-308-8843 / West Coast: 1-888-419-2564. **DO NOT leave any problem unresolved.** If you must wait for the following workday to call B.E.A., leave the door inoperable until satisfactory repairs can be made. **NEVER sacrifice the safe operation of the automatic door or gate for an incomplete solution.**
Web: www.beasensors.com